



Maps 4 Smart Building

Peter Szymeczko - BIM System Manager

Maps 4 Smart Building

Enabler, Use Cases & Stakeholders

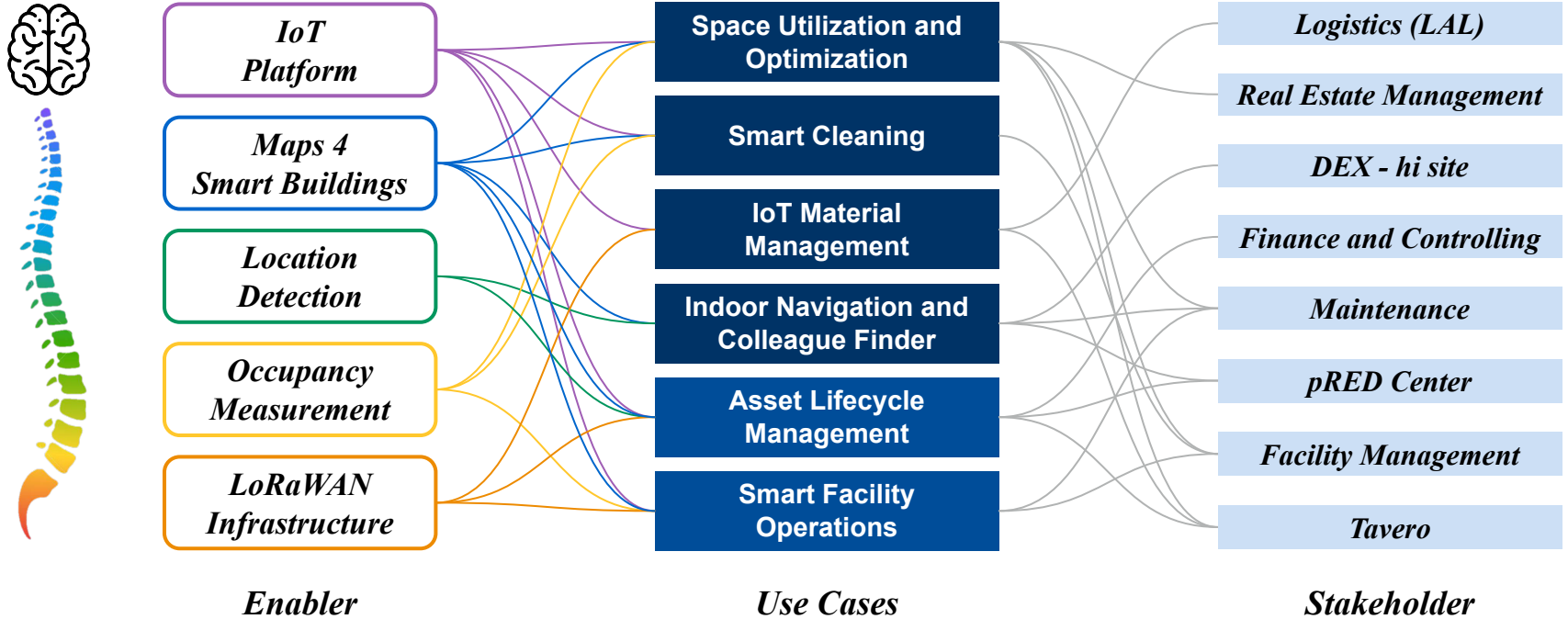

Maps 4 Smart Building

What does it provide?

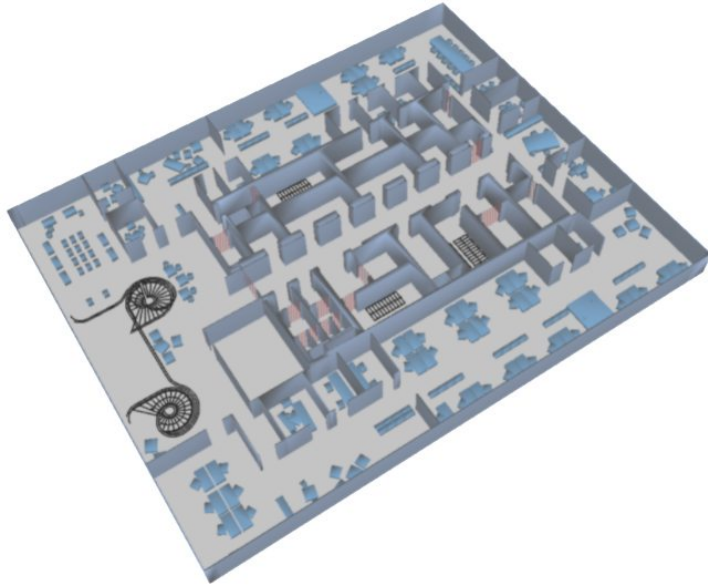

- ✓ *Digitalised and georeferenced consistent maps of buildings*

- ✓ *Building structure data*

- ✓ *Architectural and CAFM information in a simple and standardized form*

- ✓ *Automated Cloud-based service for future proof*

- ✓ *Automated process (Maps don't need to be updated manually when changed)*

Maps 4 Smart Building

Highlevel Illustration of floor maps flow

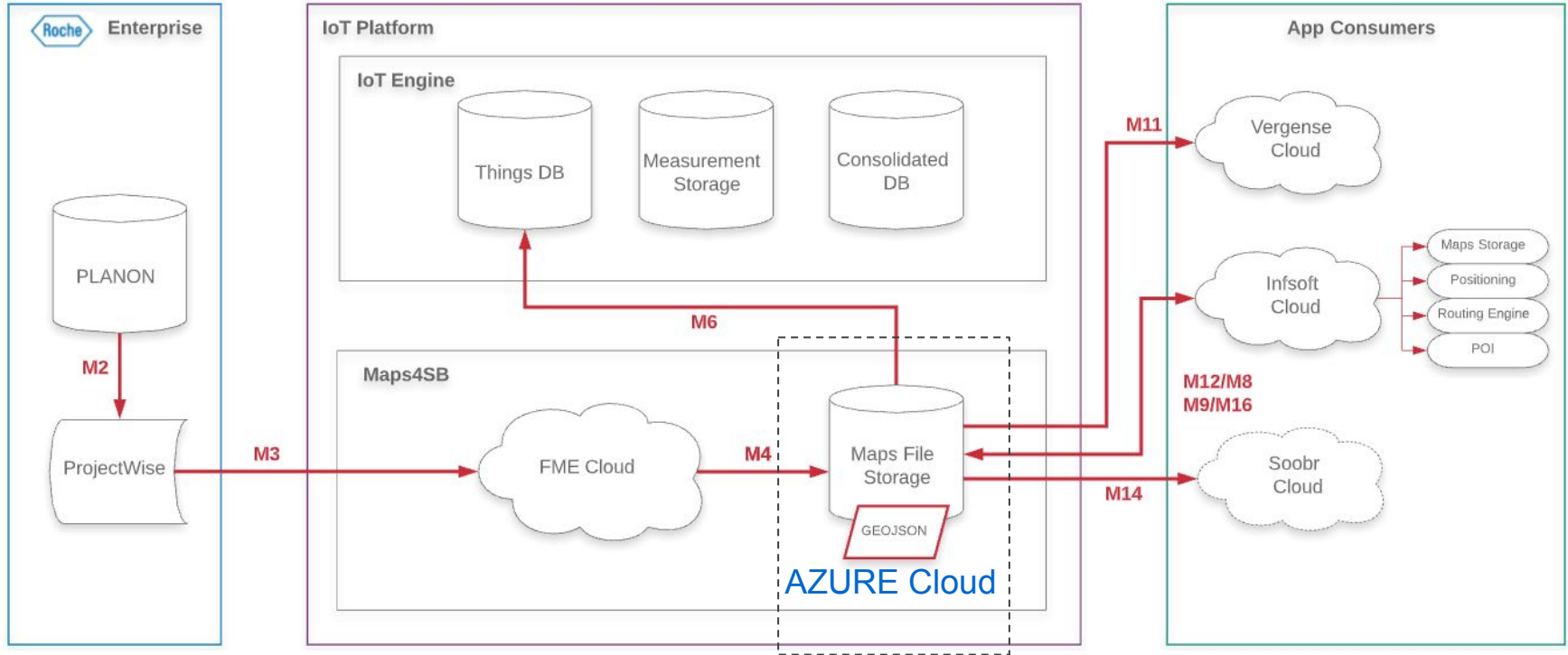

Maps 4 Smart Building

Further enablers and use cases based on FME solution

Digital Twin in design for showcase Innolab Bldg 8

Full automated Cloud based solution (concept phase)

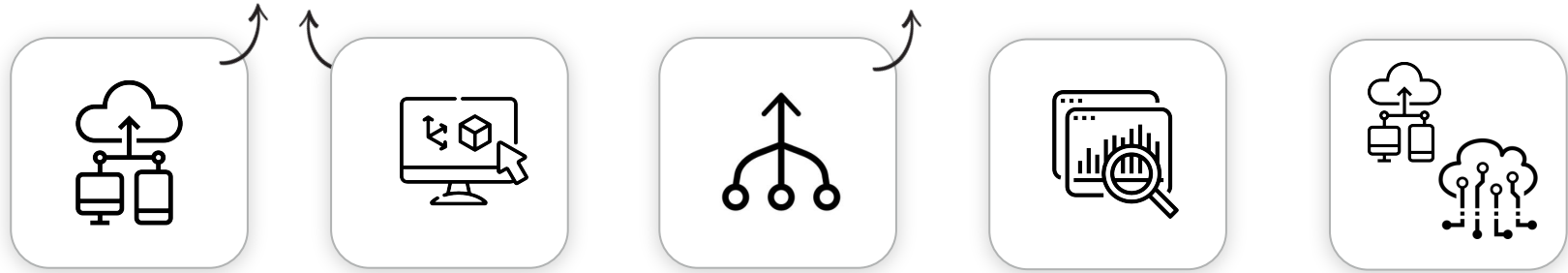

CAFM

Data Integration Platform

Automated QS-Check

API pRED PKM + BIM360

IoT and PoI

Same GeoJSON data from CAFM are already implemented in the Digital Twin

FME Software is used as a data integration platform for the Digital Twin

QS-Check of CAD/BIM models according to Elvis and SAP specifications
[QS-CAD/BIM](#)

FME Software is used as an interface in pRED Project for data transferring from PKM to BIM360 Construction Cloud

FME Software could be use for linking sensor data (IoT) and Points of Interest (PoI) for Digital Twin (Not yet launched)

Maps 4 Smart Building

Technical challenges

Task: Merge DWG and Excel data (Planon), producing GeoJSON files on MS Azure

- Roche on-premise FME Server not ready
 - Solution: FME Cloud was perfect to get the MVP up and running quickly, all the input files are available on the Roche ProjectWise portal. We could then migrate on-premises later.
- Do we get DWG or DGN files as input?
 - Solution: No problem for FME, just add the appropriate reader!
- Room numbers: a question of CAD vs GIS

Or: “Just use the PointOnAreaOverlayer, how hard could it be?”

 - Solution: Manual corrections and lots and lots of transformers.
- Discrepancies between data sources
 - Solution: Workspace creates user-friendly text logs outlining any problematic areas needing manual revision.

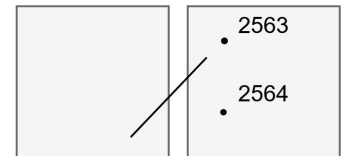
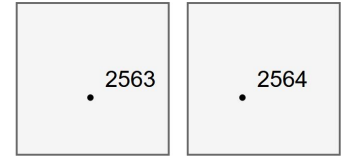

Doing now what patients need next